

BASIC DETAILS

40596--M R C R PUBLIC SCHOOL HANSI RD JULANA JIND HRY

Dated : 26/09/2020

SCHOOL NAME	M R C R PUBLIC SCHOOL HANSI RD JULANA JIND HRY	SCHOOL CODE	40596
ADDRESS	MRCR PUBLIC SCHOOL,HANSI ROAD OPP MARKET COMMITTEE,JULANA	AFFILIATION CODE	530615
PRINCIPAL	MRS KIRAN BALA	PRINCIPAL'S CONTACT NUMBER	9813116344
PRINCIPAL'S EMAIL ID	mrcrjulana@gmail.com	PRINCIPAL'S RETIREMENT DATE	10/09/2032
SCHOOL'S CONTACT NUMBER	1683-275333	SCHOOL'S EMAIL ID	mrcrjulana@gmail.com
SCHOOL'S WEBSITE	mrcrpublicschool.co.in	SCHOOL'S FAX NUMBER	274305
LANDMARK NEAR SCHOOL	MARKET COMMITTEE	YEAR OF ESTABLISHMENT	2002
AFFILIATION VALIDITY	2006 TO 2022	AFFILIATION STATUS	PROVISIONAL
NAME OF THE TRUST/SOCIETY/COMPANY REGISTERED WITH	MANGERAM CHETRAM EDUCATION SOCIETY	REGISTRATION DATE	10/08/2001
SOCIETY REGISTRATION NUMBER	1296	REGISTRATION VALIDITY	PERMANENT REGISTRATION
NOC ISSUING AUTHORITY	DIRECTOR OF SCHOOL EDUCATION	NOC ISSUING DATE	09/03/2007
NO OBJECTION CERTIFICATE	VIEW (PdfHandler.aspx? FileName=G:\cbse\2018\oasis\noc\40596.PDF)	NON PROPRIETARY CHARACTER AFFIDAVIT/NON PROFIT COMPANY AFFIDAVIT	VIEW (PdfHandler.aspx? FileName=G:\cbse\2018\oasis\

FACULTY DETAILS

40596--M R C R PUBLIC SCHOOL HANSI RD JULANA JIND HRY

Dated : 12/10/2020

TOTAL NUMBER OF TEACHERS (ALL CLASSES)	51	NUMBER OF PGTs	18
NUMBER OF TGTs	12	NUMBER OF PRTs	12
NUMBER OF PETs	01	OTHER NON-TEACHING STAFF	05
NUMBER OF MANDATORY TRAINING QUALIFIED TEACHERS	46	NUMBER OF TRAININGS ATTENDED BY FACULTY SINCE LAST YEAR	06
WHETHER SPECIAL EDUCATOR APPOINTED?	YES	WHETHER COUNSELLOR AND WELLNESS TEACHER APPOINTED?	YES
HAS MANDATORY TRAINING OF TEACHERS AS PER THE TRAINING POLICY (SECTION-16 OF AFFILIATION BYE-LAWS) (http://cbseaff.nic.in/cbse_aff/attachment/onlineservices/affiliation-Bye-Laws.pdf) BEEN COMPLETED?	YES	NUMBER OF NTTs	5

STUDENT DETAILS

40596--M R C R PUBLIC SCHOOL HANSI RD JULANA JIND HRY

Dated : 12/10/2020

CLASS	TOTAL NUMBER OF SECTIONS	TOTAL PER CLASS INTAKE	TOTAL NUMBER OF STUDENTS
1	02	55	75
2	02	65	80
3	02	70	82
4	02	60	70
5	02	70	84
6	02	65	82
7	02	62	69
8	02	65	72
9	02	62	62
10	02	70	70
11	02	64	64
12	02	43	43

ACADEMIC DETAILS

40596--M R C R PUBLIC SCHOOL HANSI RD JULANA JIND HRY

Dated : 04/03/2021

SUBJECTS OFFERED FOR CLASS 10	SUBJECTS OFFERED FOR CLASS 12
087---SOCIAL SCIENCE 184---ENGLISH LNG & LIT. 002---HINDI COURSE-A 034---HIND.MUSIC VOCAL 041---MATHEMATICS 086---SCIENCE	027---HISTORY 055---ACCOUNTANCY 044---BIOLOGY 054---BUSINESS STUDIES 043---CHEMISTRY 030---ECONOMICS 301---ENGLISH CORE 029---GEOGRAPHY 034---HIND MUSIC.VOCAL 064---HOME SCIENCE 041---MATHEMATICS 048---PHYSICAL EDUCATION 042---PHYSICS 028---POLITICAL SCIENCE 302---HINDI CORE

INFRASTRUCTURE DETAILS40596--M R C R PUBLIC SCHOOL HANSI RD JULANA JIND HRY
Dated : 07/10/2020

TOTAL NUMBER OF SITES OF SCHOOL	02	TOTAL NUMBER OF BUILDING BLOCKS	02
TOTAL AREA OF SCHOOL IN SQUARE METRES	8093	TOTAL NUMBER OF PLAYGROUNDS	02
TOTAL AREA OF PLAYGROUND IN SQUARE METRES	5450	TOTAL NUMBER OF ROOMS	46
TOTAL NUMBER OF SMALL-SIZED ROOMS	5	TOTAL NUMBER OF MEDIUM-SIZED ROOMS	5
TOTAL NUMBER OF LARGE-SIZED ROOMS	36	TOTAL NUMBER OF MALE REST ROOM	01
TOTAL NUMBER OF FEMALE REST ROOM	01	NUMBER OF GIRLS TOILET	8
NUMBER OF BOYS TOILET	8	NUMBER OF TOILETS FOR DIFFERENTLY ABLED PERSONS	0
NUMBER OF WASHROOMS FOR FEMALE STAFF	02	NUMBER OF WASHROOMS FOR MALE STAFF	02
TOTAL NUMBER OF LIBRARIES	01	NUMBER OF LABORATORIES	06
TOTAL NUMBER OF STUDENT CANTEENS	01	TOTAL NUMBER OF STAFF CANTEENS	01
NUMBER OF WATER PURIFIERS/ROs	04	NUMBER OF AUDITORIUMS	01
NUMBER OF LIFTS/ELEVATORS	0	NUMBER OF DIGITAL CLASSROOMS	09
DOES THE SCHOOL HAVE HOSTEL FACILITY	NO	DOES THE SCHOOL HAVE GUARDS EMPLOYED FOR SAFETY	YES

DOES THE SCHOOL HAVE FIRE EXTINGUISHERS	YES	DOES THE SCHOOL HAVE SPRINKLERS	YES
DOES THE SCHOOL HAVE CCTV CAMERAS INSTALLED?	YES	IS THE SCHOOL EXAMINATION CENTER OF CBSE?	YES
TOTAL NUMBER OF COMPUTERS IN ALL COMPUTER LAB	22	DOES THE SCHOOL HAVE WEB SERVERS	YES
DOES THE SCHOOL HAVE A BOUNDARY WALL?	YES	IS YOUR SCHOOL BARRIER FREE/ HAS RAMPS?	YES
DOES THE SCHOOL HAVE CLINIC FACILITY?	YES	DOES THE SCHOOL HAVE A STRONG ROOM?	YES
DOES THE SCHOOL HAVE A GYMNASIUM?	NO	IS YOUR SCHOOL WI-FI ENABLED?	YES
PROVISION OF WEB BASED LEARNING PROGRAMS?	YES	DOES THE SCHOOL HAVE FIRE ALARMS?	YES
DOES THE SCHOOL HAVE SPORTS FACILITY?	YES	DOES THE SCHOOL HAVE INDOOR GAMES FACILITY?	YES
DOES THE SCHOOL HAVE A SWIMMING POOL?	NO	DOES THE SCHOOL HAVE DANCE/MUSIC FACILITY?	YES
TOTAL NUMBER OF BUSES OWNED	11	TOTAL NUMBER OF BUSES HIRED	0
TOTAL NUMBER OF VANS/MATADORS	0	TOTAL NUMBER OF DRIVERS	11
NUMBER OF FEMALE ATTENDANTS FOR BUS DUTY	05	NUMBER OF ACTIVITY ROOMS	01
NAME OF TRANSPORT COORDINATOR	SANJAY	TRANSPORT COORDINATOR CONTACT	9466572365

BUILDING SAFETY CERTIFICATE	VIEW (PdfHandler.aspx? FileName=G:\cbse\2018\oasis\building\40596.PDF)	TRANSPORT SAFETY CERTIFICATE	VIEW (PdfHandler.aspx? FileName=G:\cbse\2018\oasis\tr
ARE THE HEALTH AND HYGIENE, TOILETS ON ALL FLOORS, SEPARATE TOILETS FOR STAFF, RAMPS, SIGNBOARDS, ETC. BEING MAINTAINED PROPERLY?	YES	IS THE SCHOOL INFRASTRUCTURE BEING USED FOR ANY COMMERCIAL ACTIVITY?	NO

LOCATION DETAILS

40596--M R C R PUBLIC SCHOOL HANSI RD JULANA JIND HRY
Dated : 05/10/2020

NEAREST NATIONALISED BANK	STATE BANK OF INDIA	DISTANCE OF BANK FROM SCHOOL IN KM	0.5
NEAREST BUS STATION	JULANA	DISTANCE OF BUS TERMINAL FROM SCHOOL IN KM	1
NEAREST RAILWAY STATION	JULANA	DISTANCE OF RAILWAY STATION FROM SCHOOL IN KM	0.2
NEAREST AIRPORT	DELHI	DISTANCE OF AIRPORT FROM SCHOOL IN KM	100
NEAREST HOSPITAL	JULANA	DISTANCE OF HOSPITAL FROM SCHOOL IN KM	1
NEAREST POLICE STATION	JULANA	DISTANCE OF POLICE STATION FROM SCHOOL IN KM	1.2
NEAREST METRO STATION	BAHADURGARH	DISTANCE OF METRO FROM SCHOOL IN KM	75

CONTRIBUTION TOWARDS ENVIRONMENT PROTECTION40596--M R C R PUBLIC SCHOOL HANSI RD JULANA JIND HRY
Dated : 07/10/2020

WHETHER RAIN WATER HARVESTING HAS BEEN DONE IN THE CAMPUS?	YES	WHETHER ROOF WATER HARVESTING IS BEING UNDERTAKEN BY THE SCHOOL?	YES
WHETHER HARVESTED WATER IS RECYCLED FOR GARDENING, ETC?	YES	WHETHER SCHOOL ENSURES MAINTENANCE OF ALL WATER FAUCETS/PIPES ETC TO PREVENT ANY LEAKAGES?	YES
WHETHER SEGREGATION OF WASTE IS DONE AT SOURCE?	YES	WHETHER ORGANIC WASTE IS BEING RECYCLED?	NO
WHETHER WASTE PAPER IS RECYCLED?	NO	WHETHER SCHOOL IS MAKING EFFORTS TO REDUCE USE OF PAPER BY ADOPTING IT SOLUTIONS?	YES
WHETHER THERE IS PROPER DISPOSAL OF SOLID WASTE?	YES	WHETHER THERE IS A SYSTEM FOR DISPOSAL OF ELECTRONIC WASTE?	NO
WHETHER SCHOOL IS USING ENERGY SAVING AND ENERGY EFFICIENT ELECTRICAL EQUIPMENT?	YES	WHETHER PLANTATION/GARDENING HAS BEEN DONE IN AND AROUND CAMPUS?	YES
WHETHER DRIP IRRIGATION IS THE ONLY MEANS OF WATERING THE GARDEN?	YES	WHETHER SCHOOL IS USING SOLAR ENERGY?	NO
WHETHER WASTE WATER FROM RO PLANT FOR DRINKING WATER IS BEING HARVESTED/RECYCLED?	NO	WHETHER SCHOOL IS PROMOTING AWARENESS AMONGST CHILDREN AND PARENTS ON ENVIRONMENTAL CONSERVATION AND CLEANLINESS?	YES
WHETHER CHILDREN ARE BEING TAUGHT HOW TO AUDIT THE USE OF WATER AND WHETHER THEY ARE BEING ENCOURAGED TO TAKE IT UP AT HOME?	YES	WHETHER CHILDREN ARE TAKING UP WATER AUDITING AT SCHOOL?	YES
WHETHER ENVIRONMENTAL LITERACY IS PROMOTED THROUGH INTEGRATION IN ACADEMICS?	YES	WHETHER TREES HAVE BEEN PLANTED BY STUDENTS, IN SCHOOL AT HOME/IN NEIGHBOURHOOD IN THE CURRENT ACADEMIC YEAR?	YES
WHETHER CONSERVATION OF ENVIRONMENT IS PROMOTED?	YES	TOTAL TREES PLANTED? (BY STUDENTS AND TEACHERS)	350
TOTAL AMOUNT OF WATER CONSERVED (IN LITRES)? (BY STUDENTS AND TEACHERS)	1000	TARGET DATE FOR STOPPING USE OF POLYTHENE	10/25/2020

OTHER VITAL INFORMATION40596--M R C R PUBLIC SCHOOL HANSI RD JULANA JIND HRY
Dated : 14/10/2020

10th BOARD PASS PERCENTAGE (2014/2015/2016)	81.25/100/98.5	12th BOARD PASS PERCENTAGE (2014/2015/2016)	70/90.47/96
NAME OF WELLNESS/ACTIVITY TEACHER	YES	NAME OF GRIEVANCE/COMPLAINT REDRESSAL OFFICER	SAROJ
CONTACT NUMBER OF GRIEVANCE/COMPLAINT REDRESSAL OFFICER	9416934036	EMAIL ID OF GRIEVANCE/COMPLAINT REDRESSAL OFFICER	mrcrjulana@gmail.com
NAME OF HEAD OF SEXUAL HARASSMENT COMMITTEE	ANJU BALA	CONTACT NUMBER OF HEAD OF SEXUAL HARASSMENT COMMITTEE	9992292896
EMAIL ID OF HEAD OF SEXUAL HARASSMENT COMMITTEE	mrcrjulana@gmail.com	NAME OF CONTACT PERSON IN CASE OF EMERGENCY	ARUN SINGLA
CONTACT NUMBER OF CONTACT PERSON IN CASE OF EMERGENCY	9416301010	EMAIL ID OF CONTACT PERSON IN CASE OF EMERGENCY	arun.singhal51@gmail
TOTAL NUMBER OF DOCTORS IN SCHOOL CLINIC	0	TOTAL NUMBER OF NURSES IN SCHOOL CLINIC	01
TOTAL NUMBER OF BEDS IN SCHOOL CLINIC	02	LEVEL OF INVOLVEMENT OF SCHOOL IN CBSE ACTIVITIES	ACTIVE
DO THE TEACHERS GET PROPER GRADE LIKE PGT/TGT AS PER THE CLASSES THEY ARE ENTITLED TO TEACH?	YES	DO THE TEACHERS AND STAFF GET THEIR SALARY WITHIN FIRST WEEK OF THE MONTH?	YES
DOES THE SCHOOL HAVE EPF FACILITY FOR STAFF	YES	EPF REGISTRATION NUMBER	GNRTK0021841000
MODE OF SALARY PAYMENT	bankpayment	NAME OF BANK WITH SALARY ACCOUNT	AXIS BANK JULANA-919
ARE THE SCHOOL ACCOUNTS AUDITED REGULARLY?	YES	PARENT TEACHERS ASSOCIATION AS PER NORMS	YES
ACADEMIC SESSION	APRIL TO MARCH	VACATION PERIOD	MAY TO JUNE
AUDITED BALANCE SHEET OF SCHOOL	VIEW (PdfHandler.aspx? FileName=G:\cbse\2018\oasis\balance\40596.pdf)	STAFF STATEMENT OF SCHOOL	VIEW (PdfHandler.aspx? FileName=G:\cbse\2018\oasis\income\40596.pdf)
INCOME AND EXPENDITURE STATEMENT	VIEW (PdfHandler.aspx? FileName=G:\cbse\2018\oasis\income\40596.pdf)	ACADEMIC CALENDAR OF SCHOOL	VIEW (PdfHandler.aspx? FileName=G:\cbse\2018\oasis\income\40596.pdf)

BEST PRACTICES OF SCHOOL	
STAGE INVOLVEMENT ENGLISH CLUB SPECIAL ASSEMBLY. WEEK WISE RANKING. QUIZ:- Science, Maths, S.st, G.K. TEEJ MELA. ART & SCIENCE CELEBRATION. PARTICIPATION FOR SAHODAYA INTER SCHOOL ACTIVITIES. DECLAMATION & DEBATES.	

OTHER INFORMATION

MANDATORY ART EDUCATION FROM CLASS 1 TO 10 -TWO PERIOD A DAY	YES	WHETHER SELECTION OF TEXTBOOKS FOR ALL NORMS ((SECTION-2.4.7 (A) OF AFFILIATION BYE-LAWS) (http://cbseaff.nic.in/cbse_aff/attachment/onlinelawsbyelaws.pdf))?
WHETHER LIST OF PRESCRIBED BOOKS ARE PUBLISHED ON SCHOOL WEBSITE WITH WRITTEN DECLARATION AS PER (SECTION-2.4.7 (B) OF AFFILIATION BYE-LAWS) (http://cbseaff.nic.in/cbse_aff/attachment/onlineservices/affiliationbyelaws.pdf)?	YES	WHETHER INFORMATION AS PER PARA (2.4.9 OF AFFILIATION BYE-LAWS) (http://cbseaff.nic.in/cbse_aff/attachment/onlinelawsbyelaws.pdf) PUBLISHED ON THE SCHOOL WEBSITE?
WHETHER ALL GUIDELINES RELATED TO POCSO ACT COMPLIED WITH AS PER (SECTION-14.25 OF AFFILIATION BYE-LAWS) (http://cbseaff.nic.in/cbse_aff/attachment/onlineservices/affiliationbyelaws.pdf)?	YES	WHETHER ANNUAL REPORT CONTAINS INFORMATION AS PER (SECTION-14.5 OF AFFILIATION BYE-LAWS) (http://cbseaff.nic.in/cbse_aff/attachment/onlinelawsbyelaws.pdf)?
WHETHER DISABLED STUDENTS FACILITATED AS PER (SECTION-14.15 OF AFFILIATION BYE-LAWS) (http://cbseaff.nic.in/cbse_aff/attachment/onlineservices/affiliationbyelaws.pdf)?	YES	WHETHER IN-SERVICE TRAINING ORGANISED AS PER (SECTION-14.15 OF AFFILIATION BYE-LAWS) (http://cbseaff.nic.in/cbse_aff/attachment/onlinelawsbyelaws.pdf)?
WHETHER ANNUAL HEALTH CHECK-UP OF STUDENTS DONE AND THEIR RECORDS MAINTAINED ?	YES	NUMBER OF TEACHERS IN SCHOOL WHO DOWNLOADED SHIKSHA VANI

PEDAGOGICAL PLAN

ADOPTION OF EXPERIENTIAL LEARNING PEDAGOGY -IN WHICH GRADES	VI,VII,VIII,IX,X,XI,XII	WHETHER ANNUAL PEDAGOGICAL PLANS PREPARED, SUBMITTED AND IMPLEMENTATED ?	YES
NUMBER OF TEACHERS TRAINED ON THE ANNUAL THEME OF CBSE - EXPERIMENTAL LEARNING AND INNOVATIVE PEDAGOGY	30		

FEE STRUCTURE OF SCHOOL

40596--M R C R PUBLIC SCHOOL HANSI RD JULANA JIND HRY
Dated : 14/10/2020

CLASS	ADMISSION FEE (in Rupees)	TUITION FEE (in Rupees)	YEARLY DEVELOPMENT CHARGES (in Rupees)	ANNUAL/MONTHLY OTHER CHARGES FOR OTHER FACILITIES (in Rupees)
PRIMARY	0	1850	0	0
MIDDLE	0	1990	0	0
SECONDARY	0	2150	0	0
SENIOR SECONDARY	0	2750	0	0

PHOTO OF SCHOOL
SCHOOL PHOTOS

40596--M R C R PUBLIC SCHOOL HANSI RD JULANA JIND HRY
Dated :

GEO-TAGGED PHOTO

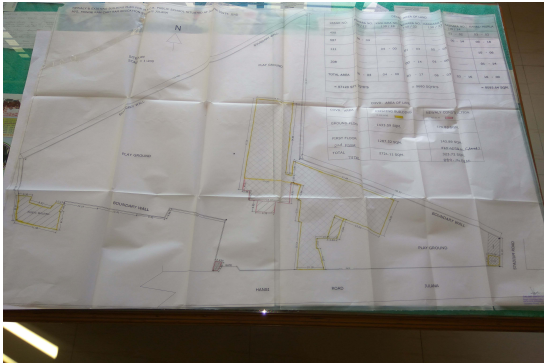

PLAYGROUND PHOTO



LIBRARY PHOTO



SCIENCE LAB PHOTO



PHYSICS LAB PHOTO**CHEMISTRY LAB PHOTO****BIOLOGY LAB PHOTO****TOILET PHOTO****ADDITIONAL INFORMATION****U-DISE CODE****SCHOOL LOCATED IN RURAL OR URBAN AREA****HABITATION NAME/MOHALLA**

40596--M R C R PUBLIC SCHOOL HANSI RD JULANA JIND HRY

Dated : 07/10/2020

06090202210

URBAN

JULANA

VILLAGE NAME (FOR RURAL)/WARD NUMBER (FOR URBAN)	JULANA
VILLAGE PANCHAYAT NAME (FOR RURAL)	JULANA
PIN CODE	126101
CLUSTER RESOURCE CENTER NAME	GOVT GIRLS SR SEC SCHOOL JULANA
CD BLOCK MANDAL/TALUKA NAME	JULANA
EDUCATIONAL ZONE/MANDAL/TALUKA NAME	JULANA
ASSEMBLY CONSTITUENCY	JULANA
MUNICIPALITY	JULANA
IS THIS SCHOOL APPROACHABLE BY ALL WEATHER ROAD	YES
IS THIS A SPECIAL SCHOOL FOR CWSN	NO
IS THIS A SHIFT SCHOOL	NO
IS THIS A RESIDENTIAL SCHOOL	NO
TYPE OF RESIDENTIAL SCHOOL	PRIVATE
IS THIS A RELIGIOUS MINORITY SCHOOL	NO
TYPE OF RELIGIOUS MINORITY SCHOOL	
NUMBER OF ACADEMIC INSPECTIONS DURING LAST ACADEMIC YEAR	1
NUMBER OF VISITS BY CRC COORDINATOR DURING LAST ACADEMIC YEAR	0
NUMBER OF VISITS BY BLOCK LEVEL OFFICER DURING LAST ACADEMIC YEAR	0

SCHOOL PARTICULARS FOR ELEMENTARY SCHOOLS ONLY 40596--M R C R PUBLIC SCHOOL HANSI RD JULANA JIND HRY
Dated : 07/10/2020

NUMBER OF INSTRUCTIONAL DAYS DURING LAST ACADEMIC YEAR

SCHOOL HOURS FOR CHILDREN PER DAY (CURRENT YEAR)

SCHOOL HOURS FOR TEACHERS PER DAY (CURRENT YEAR)

ARE PUPIL CUMULATIVE RECORDS BEING MAINTAINED?

ARE PUPIL CUMULATIVE RECORDS SHARED WITH PARENTS?

NUMBER OF STUDENTS PROVIDED IN SPECIAL TRAINING (CURRENT YEAR)

NUMBER OF STUDENTS ENROLLED IN SPECIAL TRAINING (PREVIOUS YEAR)

NUMBER OF STUDENTS COMPLETED SPECIAL TRAINING (PREVIOUS YEAR)

HAS SCHOOL MANAGEMENT COMMITTEE (SMC) BEEN CONSTITUTED?

LANGUAGES TAUGHT AT PRIMARY STAGE: MENTION THE NAME OF LANGUAGE OPTIONAL

IS ANGANWADI CENTRE IN OR ADJACENT TO SCHOOL? OPTIONAL

NUMBER OF MEETINGS HELD BY SMC DURING LAST ACADEMIC YEAR

WHETHER SMC PREPARE THE SCHOOL DEVELOPMENT PLAN

WHETHER SEPARATE BANK ACCOUNT FOR SMC IF YES, PROVIDE THESE DETAILS

BANK NAME

ACCOUNT HOLDER'S NAME

BANK ACCOUNT NUMBER

IFSC CODE

WHEN WAS THE TEXTBOOK RECEIVED FOR CURRENT YEAR?

WHETHER COMPLETE SET OF FREE TEXT BOOKS FOR TEACHERS LEARNING EQUIPMENT (TLE) RECEIVED?

WHETHER TLE RECEIVED FOR EACH GRADE?

WHETHER PLAY MATERIAL GAMES AND SPORTS MATERIAL AVAILABLE FOR EACH GRADE?

ARE THE MAJORITY OF PUPILS TAUGHT THROUGH THEIR MOTHER TONGUE AT PRIMARY STAGE? OPTIONAL

SCHOOL PARTICULARS FOR SECONDARY AND HIGHER SECONDARY SCHOOLS ONLY

40596--M R C R PUBLIC SCHOOL HANSI RD JULANA JIND HRY
Dated : 07/10/2020

NUMBER OF INSTRUCTIONAL DAYS DURING LAST ACADEMIC YEAR 223

SCHOOL HOURS FOR CHILDREN PER DAY (CURRENT YEAR) 6

SCHOOL HOURS FOR TEACHERS PER DAY (CURRENT YEAR) 6

ARE SCHOOL MANAGEMENT COMMITTEE (SMC) AND SCHOOL MANAGEMENT DEVELOPMENT COMMITTEE (SMDC) SAME? YES

IF NO, UPLOAD DETAILS OF SMDC

VIEW (PdfHandler.aspx?
FileName=G:\cbse\2018\oasis\smdc\530615.pdf)

PHYSICAL FACILITIES AND EQUIPMENTS

40596--M R C R PUBLIC SCHOOL HANSI RD JULANA JIND HRY
Dated : 12/10/2020

NUMBER OF CLASSROOMS BY CONDITION

PUCCA	PARTIALLY PUCCA	KUCHCHA	TENT
46	0	0	0
0	0	0	0
0	0	0	0

IS LAND AVAILABLE FOR EXPANSION OF SCHOOL ACTIVITIES? YES

IS SEPARATE ROOM AVAILABLE FOR PRINCIPAL/HEAD TEACHER? YES

IS SEPARATE ROOM AVAILABLE FOR VICE PRINCIPAL/ASSISTANT HEAD TEACHER?	YES
IS SEPARATE ROOM AVAILABLE FOR CRAFTS/CO CURRICULAR ACTIVITIES?	YES
IS STAFF QUARTERS AVAILABLE?	YES
IS HAND WASHING FACILITY AVAILABLE NEAR TOILET/URINALS ?	YES
IS ELECTRICITY CONNECTION AVAILABLE?	YES
IS AUDIO/VISUAL/PUBLIC ADDRESS SYSTEM AVAILABLE?	YES
IS LCD PROJECTOR AVAILABLE?	YES
NUMBER OF AVAILABLE PRINTERS	4
SPEED OF AVAILABLE PRINTERS	<20 PPMK
NUMBER OF PHOTOCOPIERS AVAILABLE	3
IS LEASE LINE AVAILABLE?	
SPEED OF LEASE LINE (IF AVAILABLE)	0
IS SCANNER AVAILABLE?	YES
IS RAIN WATER HARVESTING IMPLEMENTED?	YES

ENROLLMENT INFORMATION

40596--M R C R PUBLIC SCHOOL HANSI RD JULANA JIND HRY
Dated : 12/10/2020

CATEGORY WISE STUDENTS

CLASS	GENERAL	SC	ST	OBC
PRIMARY	320	26	0	32
MIDDLE	179	8	0	10
SECONDARY	122	5	0	7
SENIOR SECONDARY	76	6	0	8

MINORITY GROUP WISE STUDENTS

CLASS	MUSLIM	CHRISTIAN	SIKH	JAIN	OTHERS
PRIMARY	1	0	0	0	0
MIDDLE	0	0	0	0	0
SECONDARY	0	0	0	0	0
SENIOR SECONDARY	0	6	0	0	0

CHILDREN WITH SPECIAL NEEDS

CLASS	VISUAL IMPAIRMENT	SPEECH IMPAIRMENT	LOCOMOTIVE IMPAIRMENT	HEARING IMPAIRMENT	CEREBRAL PALSY	LEARNING DISABILITY	AUTISM	MULTIPLE DISABILITIES

1								
2								
3								
4								
5								
6								
7								
8								
9								
10								
11								
12								

MID DAY MEAL INFORMATION (Only for Government and Aided Schools)40596--M R C R PUBLIC SCHOOL HANSI RD JULANA JIND HRY
Dated : 17/09/2019

STATUS OF KITCHEN SHED (If meal prepared in school)	SOURCE OF MDM (If meal not prepared in school)
---	--

SPORTS INFORMATION40596--M R C R PUBLIC SCHOOL HANSI RD JULANA JIND HRY
Dated : 17/09/2019

☒ AEROBICS ☒ ATHLETICS ☒ BASKETBALL ☒ CHESS ☒ FOOTBALL ☒ HANDBALL ☐ JUDO ☒ KHO KHO ☐ SWIMMING ☒ TABLE TENNIS ☒ VOLLEYBALL
☐ ARCHERY ☒ BADMINTON ☐ BOXING ☒ CRICKET ☐ GYMNASTICS ☐ HOCKEY ☒ KABADDI ☐ SHOOTING ☐ TAEKWONDO ☐ TENNIS ☒ YOGA

DOES THE SCHOOL HAVE A MANDATORY SPORTS/GAMES PERIOD FROM CLASS 1 TO 12 EVERY DAY ?

FACILITY INFORMATION40596--M R C R PUBLIC SCHOOL HANSI RD JULANA JIND HRY
Dated : 17/09/2019**FACILITY PROVIDED TO PRIMARY STUDENTS**

FACILITY	GENERAL	SC	ST	OBC	MUSLIM MINORITY
FREE TEXT BOOKS					
FREE UNIFORMS					
STATE DEFINED INCENTIVES					

FACILITY PROVIDED TO UPPER PRIMARY STUDENTS

FACILITY	GENERAL	SC	ST	OBC	MUSLIM MINORITY
----------	---------	----	----	-----	-----------------

FREE TEXT BOOKS					
FREE UNIFORMS					
STATE DEFINED INCENTIVES					

FACILITY PROVIDED TO CWSN STUDENTS

FACILITY	ELEMENTARY	SECONDARY	HIGHER SECONDARY
BRAILL BOOKS/KITS			
LOW VISION KIT			
BRACES			
CRUTCHES			
WHEEL CHAIRS			
CALIPERS			
TRI CYCLES			